

When productivity matters,  
use **3M™ Foam Tapes.**

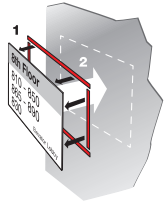

	<b>STRONG</b>	<b>STRONGER</b>	<b>STRONGEST</b>	<b>SEALING</b>
	<b>3M™ Polyethylene Foam Tape 4496B</b>	<b>3M™ Double Coated Urethane Foam Tape 4026W</b>	<b>3M™ VHB™ Tape RP45</b>	<b>3M™ Extreme Sealing Tape 4411N</b>
<b>Best For</b>	Light Duty Bonding – Replaces mechanical and liquid adhesives for interior bonding applications	General Purpose Bonding – Eliminates the need to drill holes or use messy adhesives	Heavy Duty Bonding – Strong enough to replace mechanical fasteners and adhesives	Extreme Sealing – Provides a water tight seal, replacing liquid sealants
<b>Description</b>	Closed cell double coated polyethylene foam with acrylic adhesive	Open cell double coated urethane foam tape with acrylic adhesive	Double sided conformable acrylic foam tape	Single sided soft acrylic foam tape
<b>Usage</b>	Interior	Interior	Interior/Exterior	Interior/Exterior
<b>Color</b>	Black	White	Grey	Translucent White
<b>Thickness</b>	1.6 mm	1.6 mm	1.1 mm	1.0 mm
<b>Adhesive Sides</b>	Double Sided	Double Sided	Double Sided	Single Sided
<b>Application</b>	Signs, nameplates and plaques Point of purchase and other displays Plastic hooks, racks and dispensers Appliances and electronic equipment trim Display case	Signs Soap dispensers Kick plates Nameplates Electrical channels Acoustic panels to walls Air fresheners	Interior fitout Metal enclosures – bonding lightweight skins to frames Bonding stiffeners to panels Bonding decorative materials Product assembly and lens attachment Hanging signs and letters	Roofing and skylights Rain gutters and downpipes Sheds and metal enclosures Patching and repairs Automotive, RV and caravan Flashing and vents

3M™ Polyethylene Foam Tape 4496B and Double Coated Urethane Foam Tape 4026W



Adhering signs to walls



Attaching letters

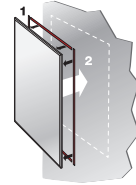

Mounting mirrors

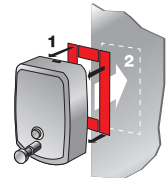

Installing soap dispensers

3M™ VHB™ Tape RP45

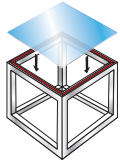

Constructing metal and plastic enclosures

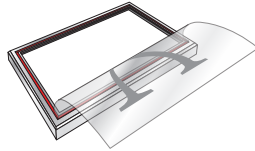

Making signs

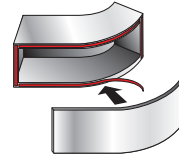

Bonding exhibit panels

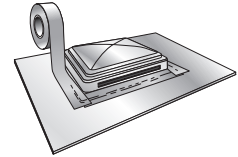

Sealing roof seams, metal enclosures and gutters

3M™ Extreme Sealing Tape 4411N

## How to Apply

**Step 1:** To obtain optimum adhesion, surfaces must be well aligned, clean and dry. Clean surface thoroughly with a 50:50 mixture of isopropyl alcohol (IPA) and water\* prior to applying 3M™ Foam Tapes.

**Step 2:** Once the surface has been cleaned, wipe completely dry.

**Step 3:** Apply the 3M Foam Tape to the surface.

**Step 4:** Firm application pressure develops better adhesive contact and helps improve bond strength. Use a J-roller to apply at least 15 psi (100 kPa) in roll down or platen pressure.

After application, the bond strength will increase. At room temperature, approximately 50% of the ultimate strength will be achieved after 20 minutes, 90% after 24 hours and 100% after 72 hours. In some cases, bond strength can be increased and ultimate bond strength can be achieved more quickly by exposing the bond to elevated temperatures (e.g. 150°F [66°C] for 1 hour).

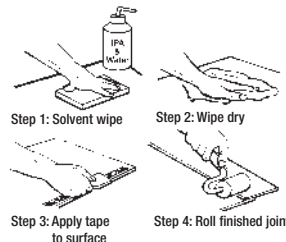

Additional surface preparation may be needed for:

**Heavy Oils:** Use degreaser or solvent-based cleaner to help remove heavy oil or grease from surface.

**Abrasion:** Abrading the surface may help remove heavy dirt or oxidation.

**Adhesion Promoters:** Priming a surface can significantly improve initial and ultimate adhesion to many materials, such as plastics and paints.

**Porous Surfaces:** Seal porous and fibred materials, such as wood, particle board, concrete, etc.

**Unique Materials:** Special surface preparation may be needed for glass and glass-like materials, copper and copper-containing metals, and plastics or rubber that contain components that migrate (e.g. plasticizers).

**\*Note:** These cleaner solutions contain greater than 250 g/l of volatile organic compounds (VOC). Please consult your local Air Quality Regulations to be sure the cleaner is compliant. When using solvents, be sure to follow the manufacturer's precautions and directions for use when handling such materials.



Scan the code to learn more about surface preparation for a variety of substrates.

**3M™ Polyethylene Foam Tape 4496B**

½ in x 5 yd



¾ in x 5 yd



**3M™ Double Coated Urethane Foam Tape 4026W**

½ in x 5 yd



¾ in x 5 yd



**3M™ VHB™ Tape RP45**

½ in x 5 yd



¾ in x 5 yd



**3M™ Extreme Sealing Tape 4411N**

1.5 in x 5 yd



**3M Industrial Adhesives and Tapes Division**

3M Center  
St. Paul, MN 55144 USA

Phone 1-800-362-3550  
Web www.3M.com/VHB

3M and VHB are trademarks of 3M.  
Please recycle. Printed in USA © 3M 2015.  
All rights reserved.  
78-9236-7278-2

**Warranty and Limited Remedy:** 3M warrants that each 3M product meets the applicable 3M product specification at the time 3M ships the product. 3M MAKES NO OTHER EXPRESS OR IMPLIED WARRANTIES OR CONDITIONS, INCLUDING ANY IMPLIED WARRANTY OR CONDITION OF MERCHANTABILITY OR FITNESS FOR A PARTICULAR PURPOSE. If the 3M product does not conform to this warranty, the sole and exclusive remedy is, at 3M's option, replacement of the 3M product or refund of the purchase price. **Limitation of Liability:** Except where prohibited by law, 3M will not be liable for any loss or damage arising from the 3M product, whether direct, indirect, special, incidental or consequential, regardless of the legal theory asserted.